

- PROPOSED LOCATION OF 57 No. UNITS**
- 05 No. 3 BED SEMI-DETACHED UNITS @ 114.2m<sup>2</sup>
  - 28 No. 2 BED TOWNHOUSES @ 86.1m<sup>2</sup>
  - 06 No. 2 BED APARTMENTS @ 87.2m<sup>2</sup>
  - 06 No. 2 BED APARTMENT S @ 65.9m<sup>2</sup>
  - 06 No. 1 BED APARTMENTS @ 57.5m<sup>2</sup>
  - 06 No. 1 BED APARTMENT S @ 54.0m<sup>2</sup>

ALLOCATED FOR PART V SHOWN IN MAGENTA

DO NOT SCALE. WORK TO FIGURED DIMENSIONS ONLY.  
 ALL EXISTING DIMENSIONS TO BE CHECKED ON SITE.  
 DRAWN ON AUTOCAD R2004 AT DEADY GAHAN ARCHITECTS LTD  
 LAYERS ON THIS DRAWING COMPLY WITH BS 1192: PART 5

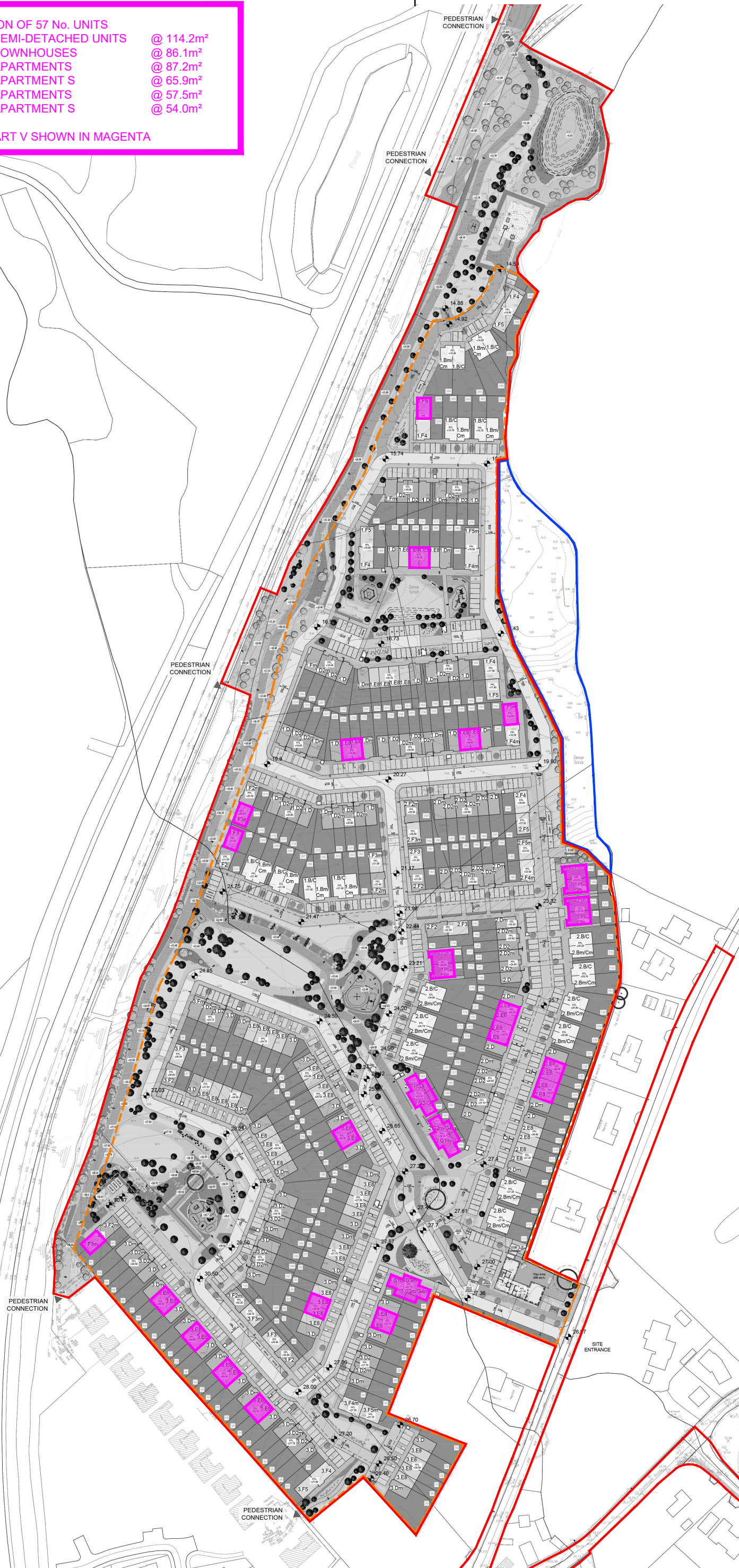
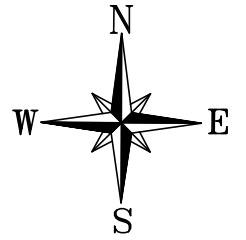

date	rev	name	chk	note
12.08.22	P1	MP	EJG	ISSUE FOR PLANNING

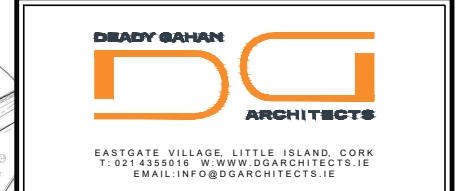

Project  
 PROPOSED RESIDENTIAL DEVELOPMENT AT  
 BALLYMACAULA, DRUMBIGGLE, CIRCULAR ROAD,  
 ENNIS, CO. CLARE

Drawing title  
 PROPOSED PART V ALLOCATION

Scale	Drawn	Checked	Date
1:2000 @ A3	MP	EJG	23.11.21
Project No. 21112	Dwg. No. 21112/P/008	Revision P1	

<input type="checkbox"/> Information / Comments	<input type="checkbox"/> Tender
<input checked="" type="checkbox"/> Planning	<input type="checkbox"/> Construction

# PROPOSED PART V ALLOCATION

SCALE 1:2000@A3